

FITMENT INSTRUCTIONS

Alu-Cab™



TOYOTA HILUX VIGO DC & XC CANOPY CAMPER

All rights reserved. No part of this document may be reproduced, translated, stored in a retrieval system, or transmitted, in any form or by any means, electronic, mechanical, photocopying, recording or otherwise, without prior written permission of the owner.

Review all instructions information carefully before installation.

Any damages, direct or incidental to the installer and/or property due to incorrect installation of any parts are the responsibility of the installer. Due to the various applications and fitment options available, the responsibility lies with the user to ensure all mounting points are secure and tight before every trip. If unsure, consult with your Distributor regarding the operations of our products.

Users are advised to be mindful of the load they are carrying and drive in accordance with road conditions.

DISCLAIMER

Alu-Cab

Mounting & Filler Kit Identification

RELEASED FOR MANUFACTURE		ITEM NO.		PART NUMBER		DESCRIPTION		QTY.	
DATE	08 June 2020	1	162-VIGO-CC-RER-FILLER-KIT-ASSY-01	REAR FILLER KIT ASSEMBLY	1				
SIGNED		2	162-VIGO-DC-CANOPY CAMPER MNT BRACKETS	CANOPY CAMPER MNT BRACKETS	1				

CC-FK-TH-05

		NAME TM DATE 27 Aug 2019 DRAWN AGF CHKD AGF APPR. AGF <small>UNLESS OTHERWISE SPECIFIED DIMENSIONS ARE IN MILLIMETERS</small>		PROJECT: VIGO DC & XC CANOPY CAMPER DESCRIPTION: FILLER & MOUNT KIT ASSEMBLY DRAWING No. CC-FK-TH05 MATERIAL: A3 FINISH: Finish PROJECTION: T=0.5 0.0±0.25 0.00±0.1 0°±0.5° THIRD ANGLE		SIZE DRAWING No. REV CC-FK-TH05 A3 SCALE: 1:20 WEIGHT: 12.8 SHEET: 1 OF 1	
--	--	-------------------------------------------------------------------------------------------------------------------------------------------------------------------------------------	--	------------------------------------------------------------------------------------------------------------------------------------------------------------------------------------------------------------------------------------------------------------	--	------------------------------------------------------------------------------------------------------------------------------------	--

4 Read Road,
Offery East, 7800,
Cape Town, South Africa
queries@alu-cab.co.za
Tel: +27 21 703 3028
Fax: +27 21 703 9510

ALL TECHNICAL & VISUAL
DATA REMAINS THE
PROPERTY OF
ALU-CAB CC & MUST BE
RETURNED UPON
REQUEST

Rear Filler Assembly - Identification

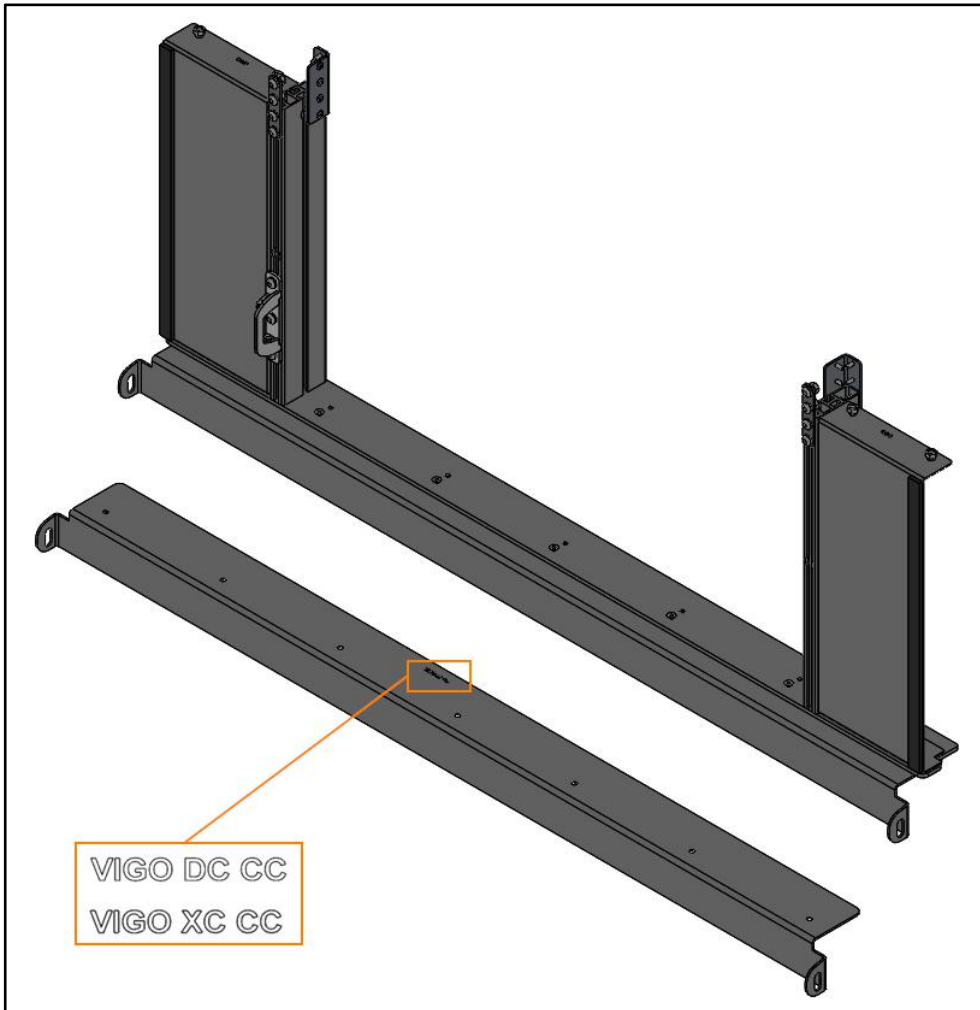

The Rear Filler Assembly is supplied with two (2) different bottom support plates, clearly labeled DC and XC - Ensure that the correct plate is fitted to this assembly, for your specific installation, before progressing.

This specific Rear Filler Assembly is supplied with the door frame / rebate connecting hardware pre-installed from the factory.



WARNING

Always wear appropriate PPE (Personal protection equipment) when fitting this product. Although the mounting kit is designed to be DIY, if you have any doubts or concerns, contact an accredited fitment centre to carry out the work. Alu-Cab will not be liable for any injury to persons, and/or damage to products and/or vehicles.

Rear Filler Assembly - Installation

Remove the tailgate from the vehicle. Keep the bolts used at the tailgate hinging points, as these will be reused.

Seat the Rear Filler Assembly into the load bin, and using the existing tailgate bolts, tighten the assembly in place, as shown below:



The above image shows the LH bolting location. The RH bolting location is mirrored on the opposite side of the tailgate opening.

Canopy Camper Base Unit - Installation & Assembly

Seating the Base Unit

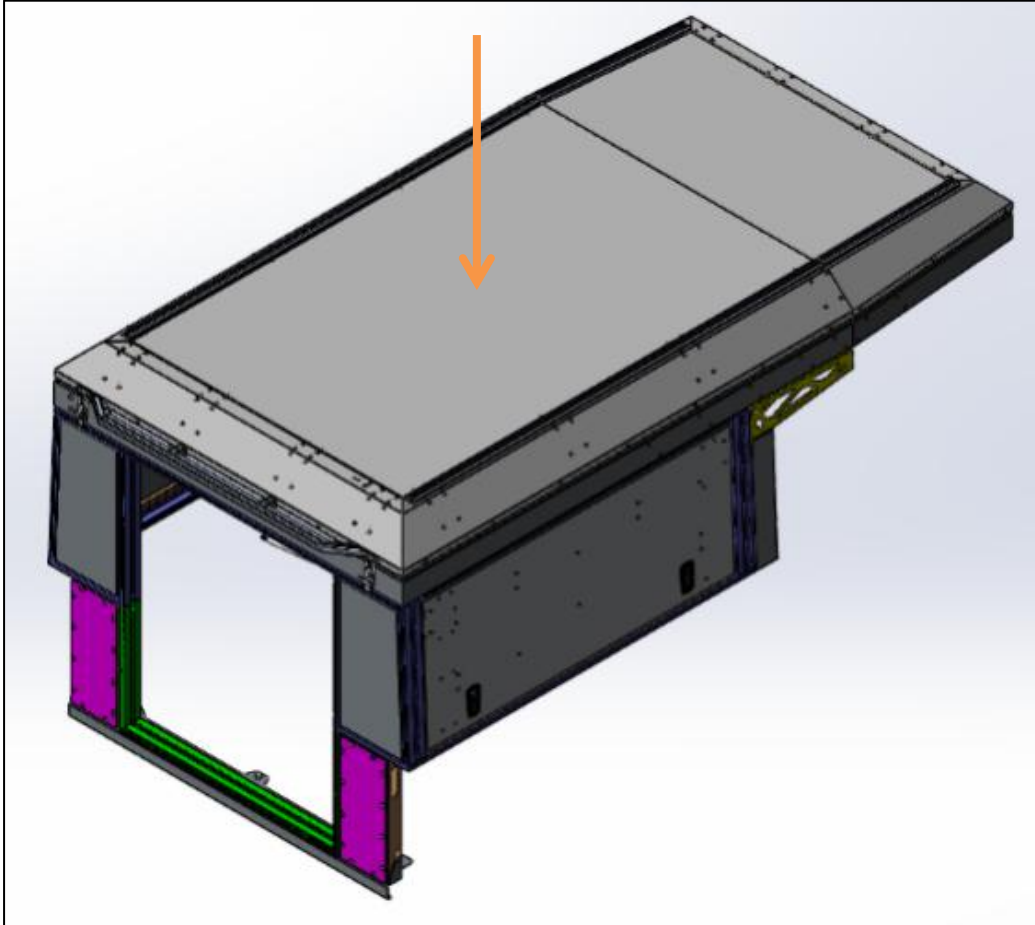

Attach the gasket material to the lower seating surface of the Canopy Camper's base frame - Refer to the stand alone Fitment Instruction for this process.

Lower the Canopy Camper Base Unit onto the already mounted Rear Filler Assembly, as shown in the image above, and align the lower and upper portions of the door frame.

Base Unit to Rear Filler Assembly Connection

Using the supplied hardware, fasten the lower and upper door frames together, on each side of the **EXTERNAL** door opening. See images below:

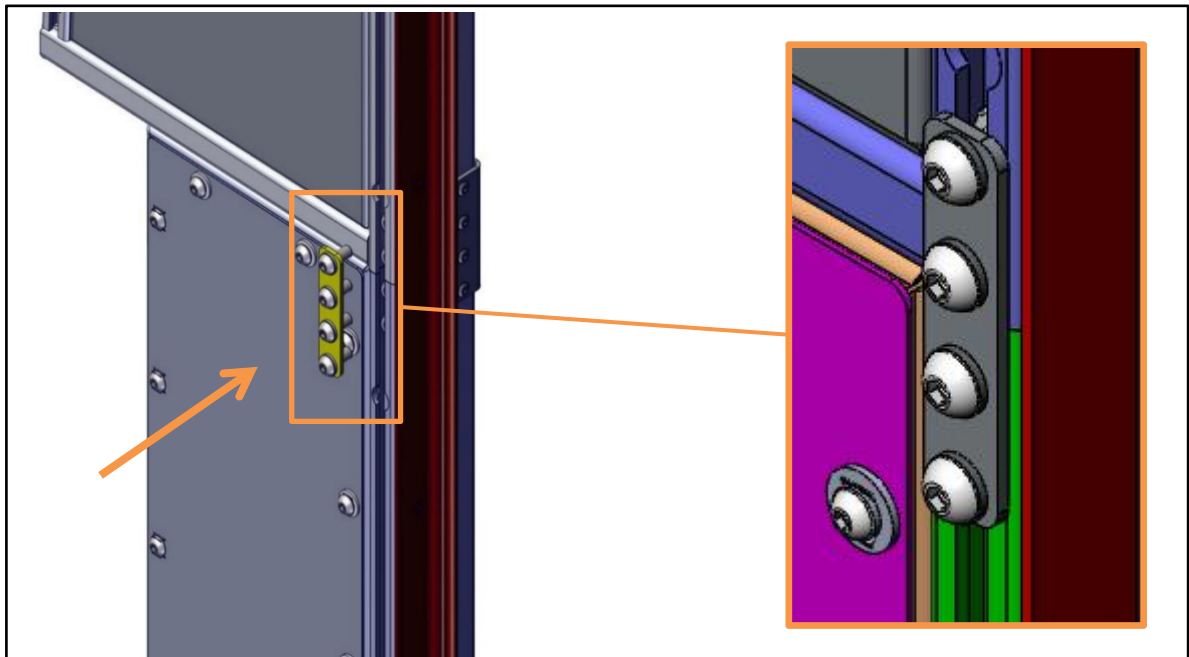

Using the supplied hardware, fasten the lower and upper door frames together, on each side of the **INTERNAL** door opening. See images below:

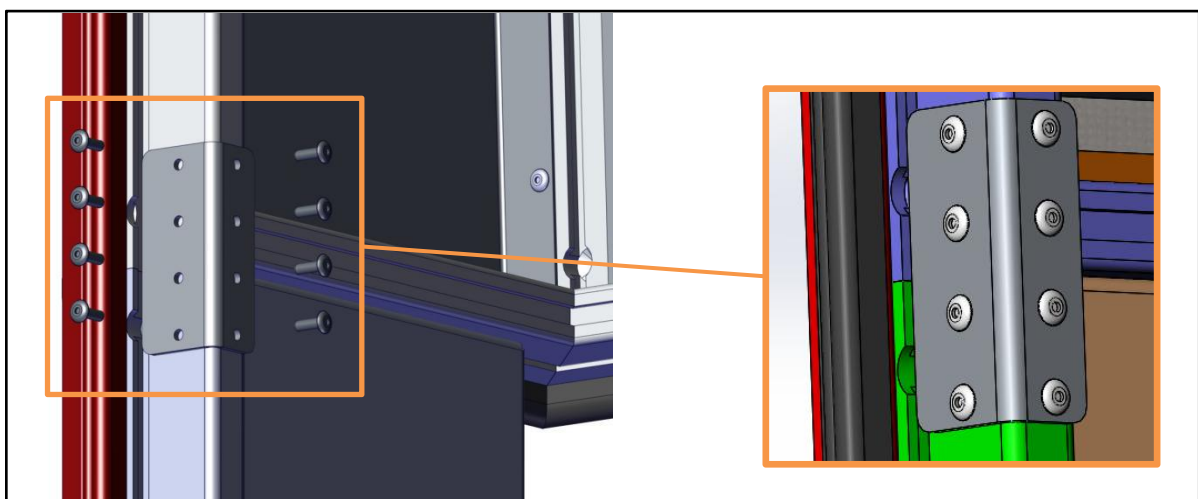

Rear Door Rebate Installation

Insert the Rear Door Rebate Frame into the door frame opening, ensure that mounting holes all align. Using the supplied hardware, rivet the frame in place along the LHS, RHS and upper mounting interfaces. See images below:

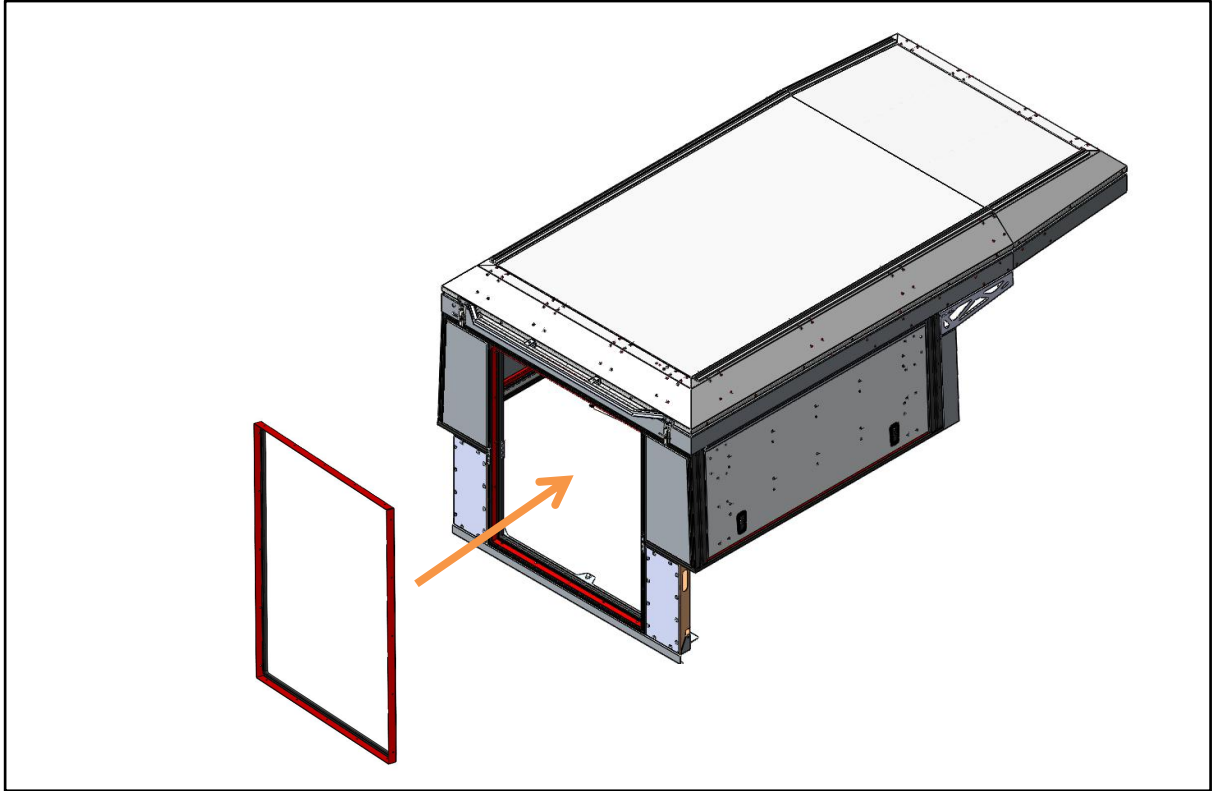

The lower mounting interface is fastened using M6 Countersunk Screws. See image below:

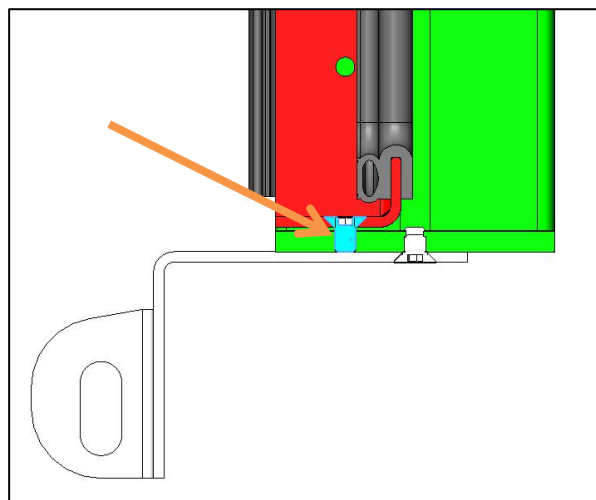

Rear Door Installation

The Rear Door Assembly is supplied fully assembled with its hinges, and the locking mechanism, as shown below:

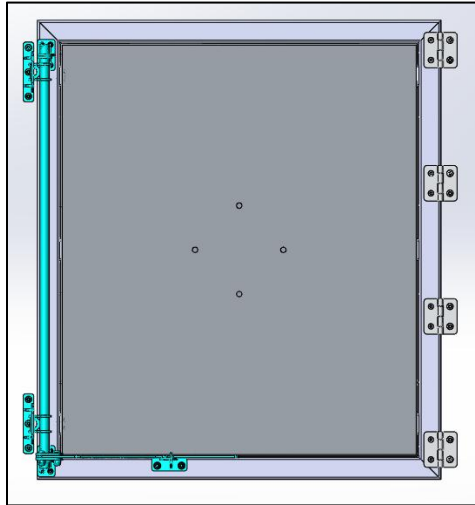

Insert the assembled door into the rear door opening. Fasten the four (4) hinges into the nut slot on the RHS door frame first, using the supplied hardware.

Align the two (2) locking mechanism Hook Brackets with the upper and lower lock tabs and fasten into the nut slot on the LHS frame, using the supplied hardware.

Installed Rear Door shown below (rear Filler Assembly removed for clarity):

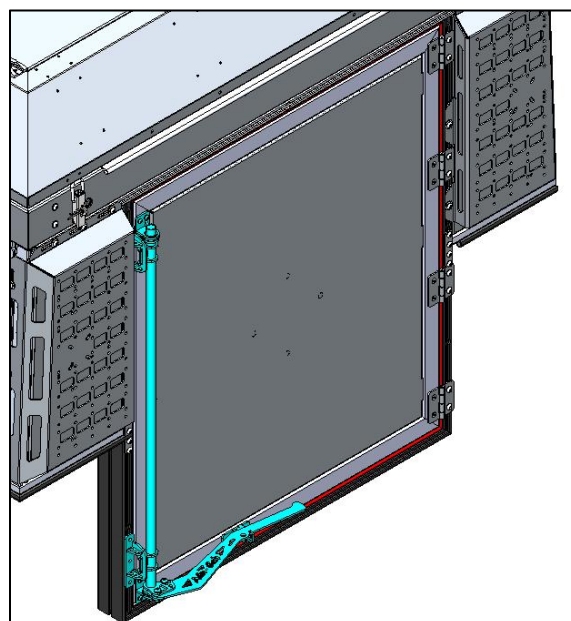

Mounting Bracket Kit - Installation

Front LH and RH Mounting Bracket Assemblies

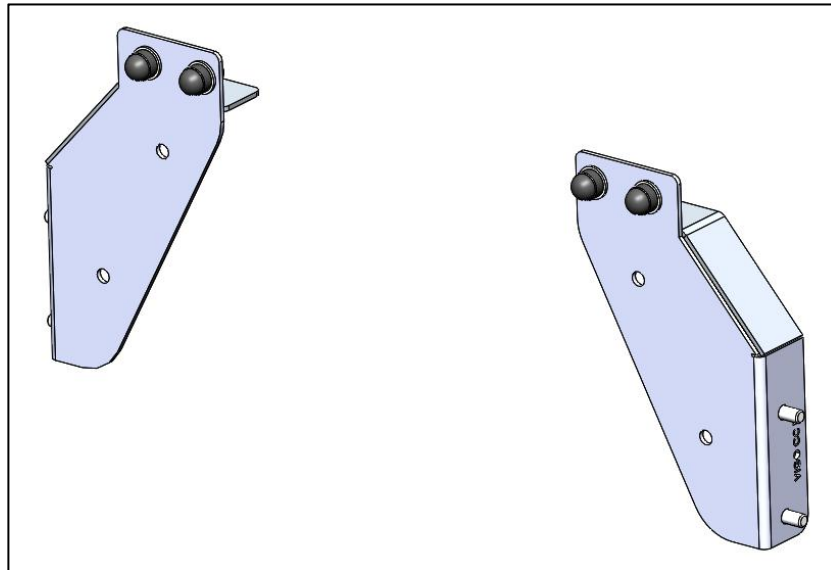

Remove the OEM tie down hooks at the front left and right of the load bin. Install the front LH and RH mounting brackets in these locations.

Mounting locations, and mounted example, indicated below:

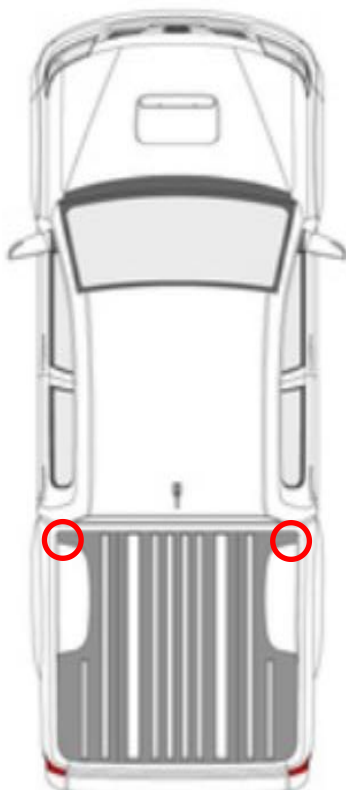

Front RH Bracket Mounting Position
(Cross section cut for clarity)

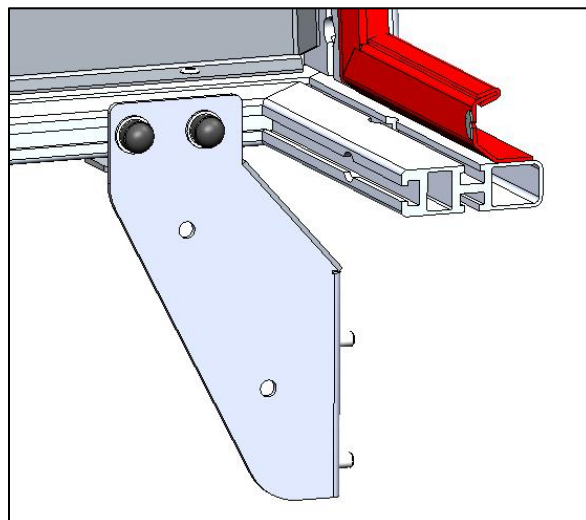

Rear LH and RH Mounting Bracket Assemblies

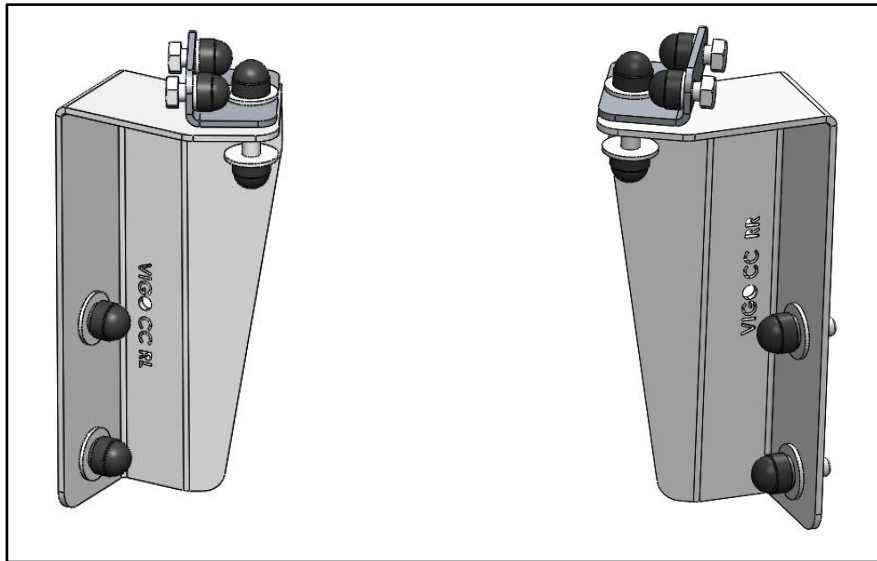

Remove the OEM tie down hooks at the rear left and right of the load bin.
Install the rear LH and RH mounting brackets in these locations.

Mounting locations, and mounted example, indicated below:

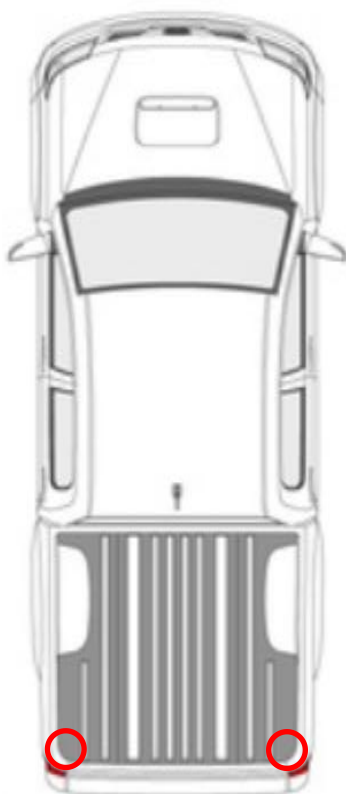

Rear RH Bracket Mounting Position
(Cross section cut for clarity)

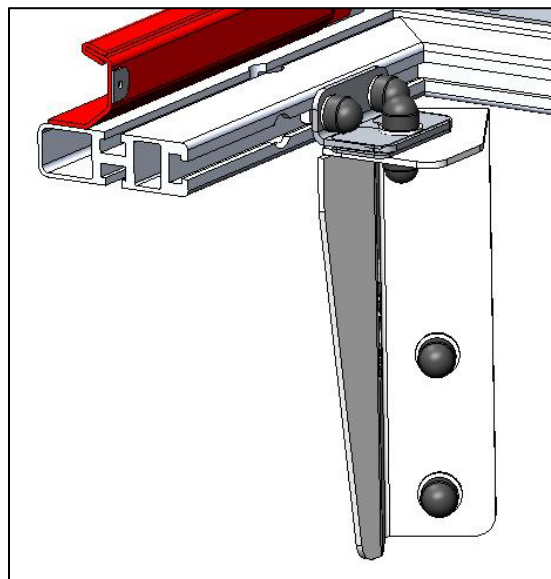

Centre Mounting Bracket Assemblies (QTY - 2)

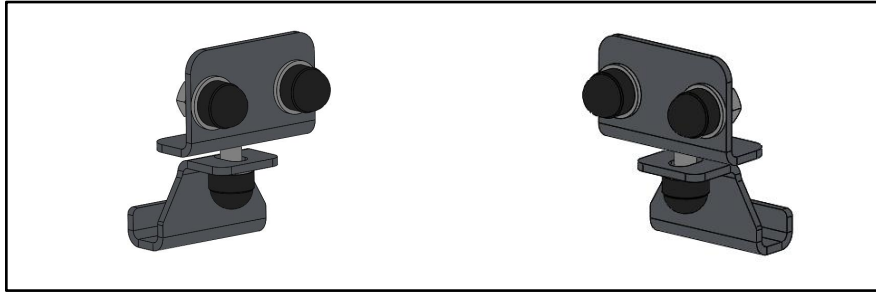

These bracket assemblies should be located midway between the front and rear mounting brackets.

The hook portion of the bracket assembly seats underneath the load bin wall lip, and the L-bracket fastens into the nut slot, on the Canopy Camper base frame. The vertical fastener should be tightened enough, so as to ensure a good seal between the Canopy Camper, and the load bin.

Mounting locations, and mounted example, indicated below:

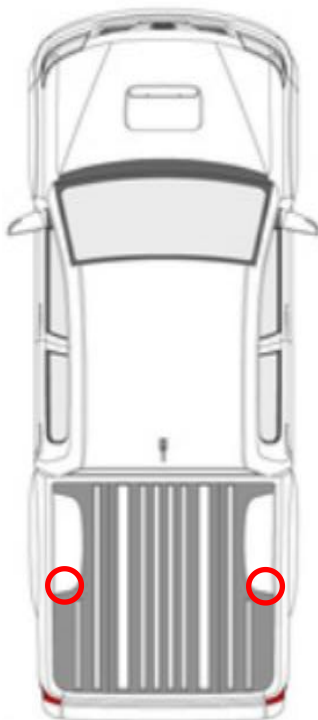

Centre Bracket Assembly Mounting Position
(Cross section cut for clarity)

