

# FITMENT INSTRUCTIONS

**Alu-Cab**<sup>TM</sup>



## Khaya Air Assist kit

All rights reserved. No part of this document may be reproduced, translated, stored in a retrieval system, or transmitted, in any form or by any means, electronic, mechanical, photocopying, recording or otherwise, without prior written permission of the owner.

Review all instructions information carefully before installation.

Any damages, direct or incidental to the installer and/or property due to incorrect installation of any parts are the responsibility of the installer. Due to the various applications and fitment options available, the responsibility lies with the user to ensure all mounting points are secure and tight before every trip. If unsure, consult with your Distributor regarding the operations of our products.

Users are advised to be mindful of the load they are carrying and drive in accordance with road conditions.

**DISCLAIMER**

**Alu-Cab**

## LIST OF COMPONENTS:

ITEM NO.	PART NUMBER	DESCRIPTION	QTY
1	429-MAIN-BOX-ASSY-01	MAIN AIR ASSIST BOX	1
2	132-HLPR-BRKT-560-RER-RHS-01	KHAYA BOTTOM HELPER BRACKET 1	1
3	132-HLPR-BRKT-560-RER-RHS-02	KHAYA HELPER TOP BRACKET RHS	1
4	132-HLPR-BRKT-560-RER-LHS-02	KHAYA HELPER TOP BRACKET LHS	1
5	132-HLPR-BRKT-560-RER-LHS-01	KHAYA AIR ASSIST BOTTOM BRACKET 1	1
6	GROM-13	GROMMET - #46	2
7	TY8	CRADLE ADHESIVE BACK	6
8	CABLE TIE	PLASTIC CABLE TIE	6
9	03016x402_6mm NERO BLACK_6m	6m NERO BLACK POLYETHELENE TUBE	1
10	DNC32X560 M8	PNEUMATIC ACTUATOR 32 X 560	2
11	132-SHK-HLP-ASSY-03	HELPER SHOCK ROOF BRACKET	1
12	132-SHK-HLP-ASSY-04	HELPER SHOCK ROOF BRACKET	1
13	FW-M6	M6x12mm FLAT WASHER S/S - DIN 125	16
14	SW-M6	M6 SPRING WASHER S/S	8
15	RIV-4810ASS	SEALED BLIND RIVET	4
16	FW-M8	M8x16mm FLAT WASHER S/S - DIN 125	4
17	BHD-M6x45	M6x45 B/HD BOLT S/S	4
18	BHD-M6x16	M6x16 B/HD DOLT S/S	8
19	BHD-M6x20	M6x20 B/HD BOLT S/S	4
20	NY-M6	M6 NYLOC NUT S/S	8
21	HEX-M8x25	M8x25 HEX BOLT S/S	4
22	NY-M8	M8 NYLOC NUT S/S	4
23	NCAP-M8	NUT CAP-08mm	4
24	MALE FEMALE ELBOW 6mm	MALE FEMALE ELBOW 6mm	2
25	SILENCER	SILENCER S/S 6mm	2
26	PLUG IN ELBOW	PLUG IN ELBOW S/S 6mm	2
27	DNC-32-560-PPV-A	PNEUMATIC CYLINDER	2
28	BKNB-M8	M8 BLACK KNOB	2

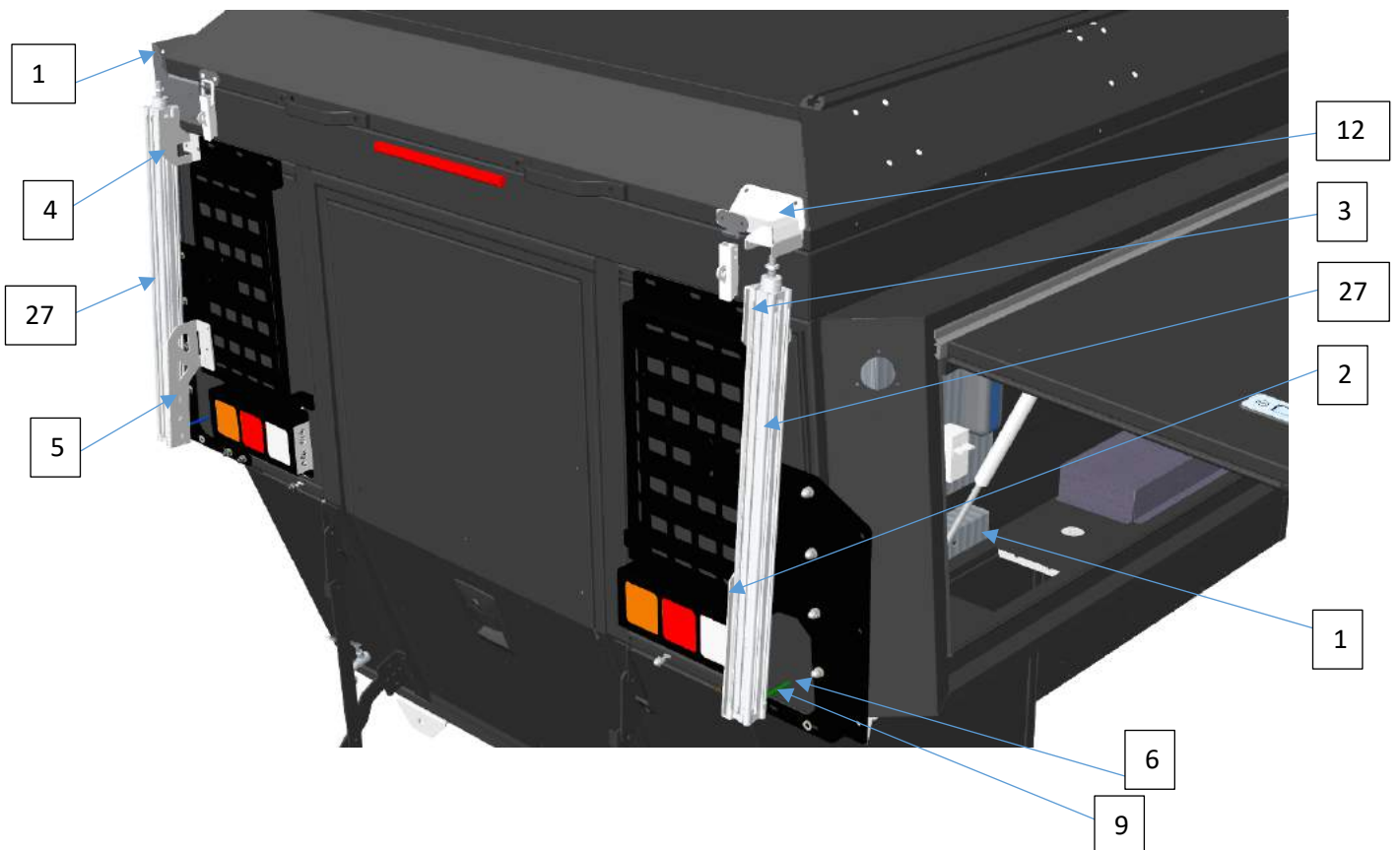

## Tools required

Tools	Purpose
10mm Spanner	Fastening Nuts and Bolts
10mm Ratchet	Fastening Nuts and Bolts
13mm Spanner	Fastening Nuts and Bolts
13mm Ratchet	Fastening Nuts and Bolts
4mm Hex	Fastening Nuts and Bolts



### **WARNING**

Always wear appropriate PPE ( Personal protection equipment) when fitting this product. Although the mounting kit is designed to be DIY, if you have any doubts or concerns, contact an accredited fitment centre to carry out the work. Alu-Cab will not be liable for any injury to persons, and/or damage to products and/or vehicles.

## 1. Drilling the pipe holes

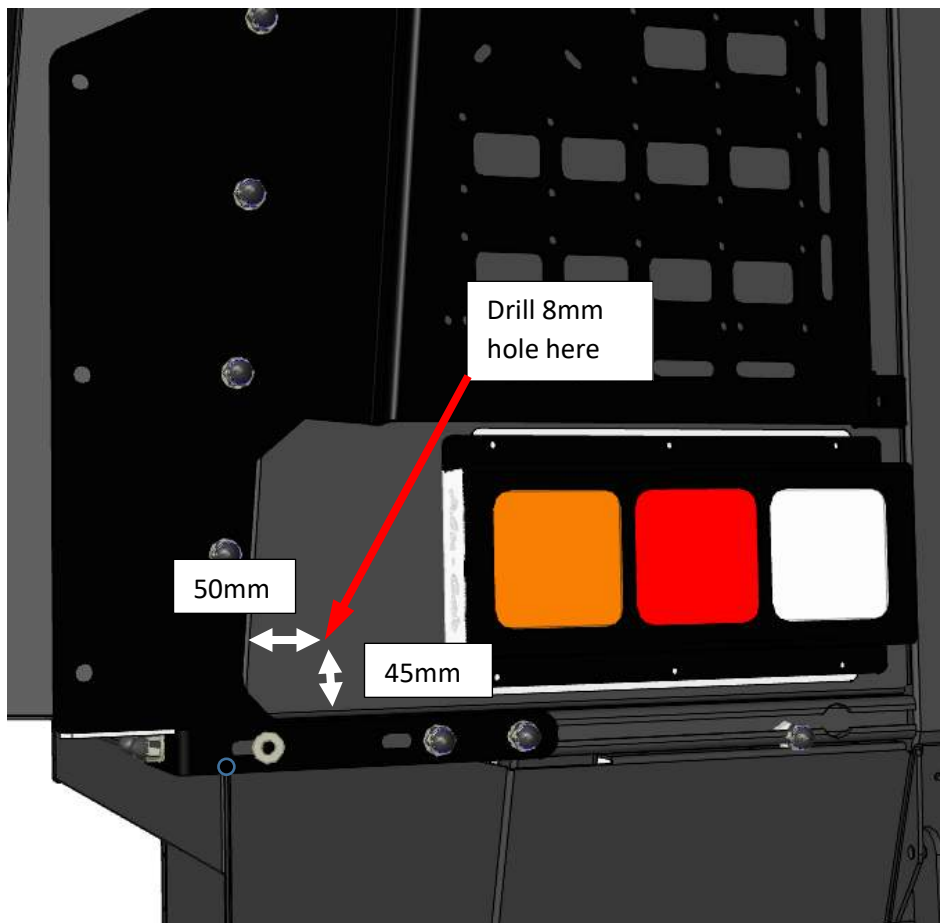

Measure 45mm from the bottom and 50mm from the side of the molle plate leg bracket and drill through the two layers of aluminium into the kitchen cupboard, as shown in the image above. Do the same on the right hand side of the vehicle at the recovery cupboard. Fit the rubber grommets supplied.

## 2. Routing the 6mm pneumatic air pipe

Route the pipe internally as shown below. There are cable holes in the top rear corners.

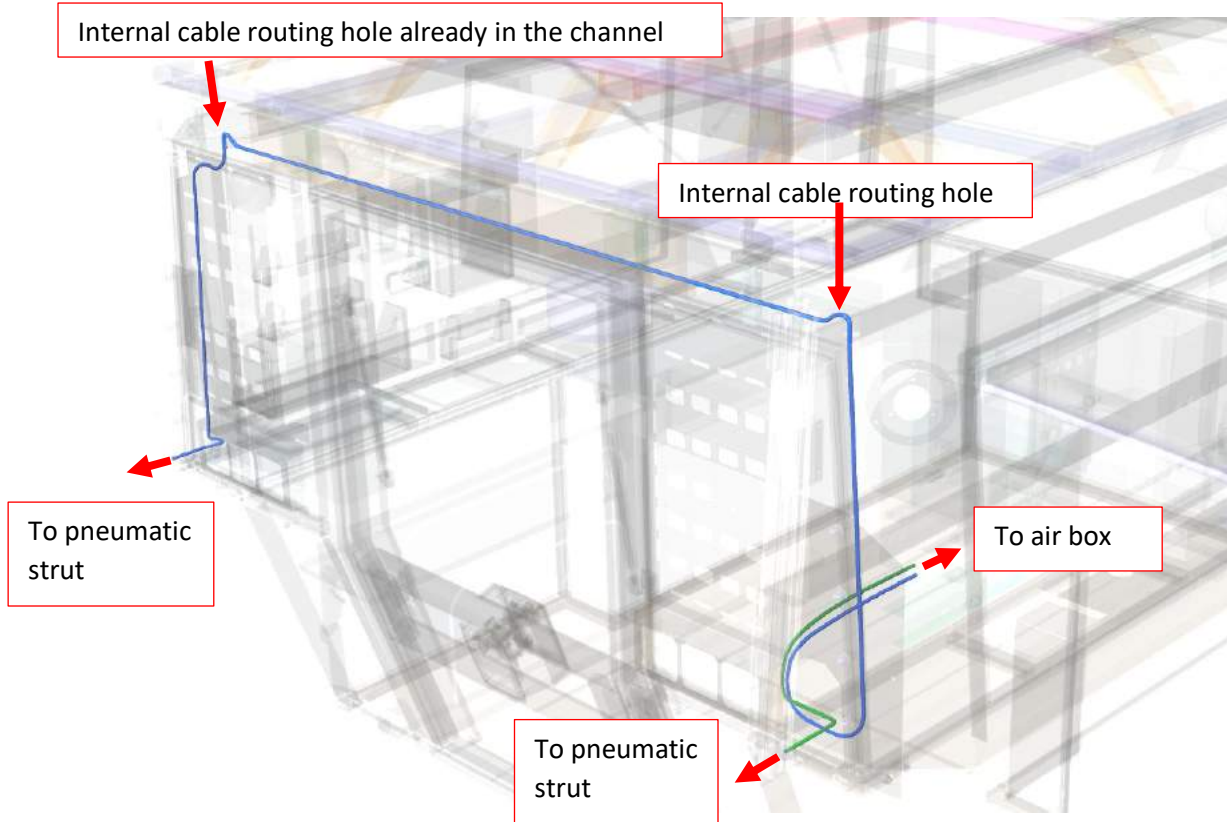

Neatly route the pipe with the cable holders supplied.



### 3. Fitting the Air Assist Brackets

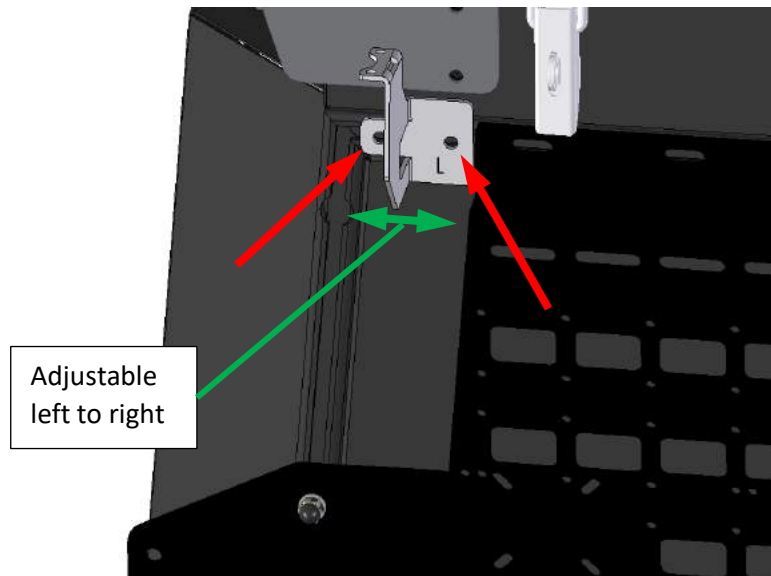

Align top bracket with the nut slot at the rear of the Khaya next to the Molle plate as shown in the image above. Where the arrows are pointing, add M8x25 hex bolts supplied into the nut slot and fasten with a M8 washer and a M8 nyloc nut supplied.

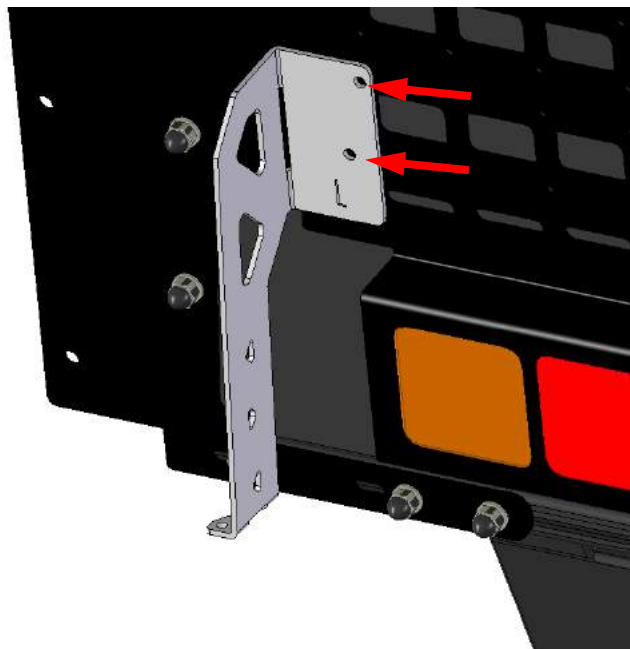

Next, align the bottom bracket and insert the M6x20 button head bolts through the Molle plate.

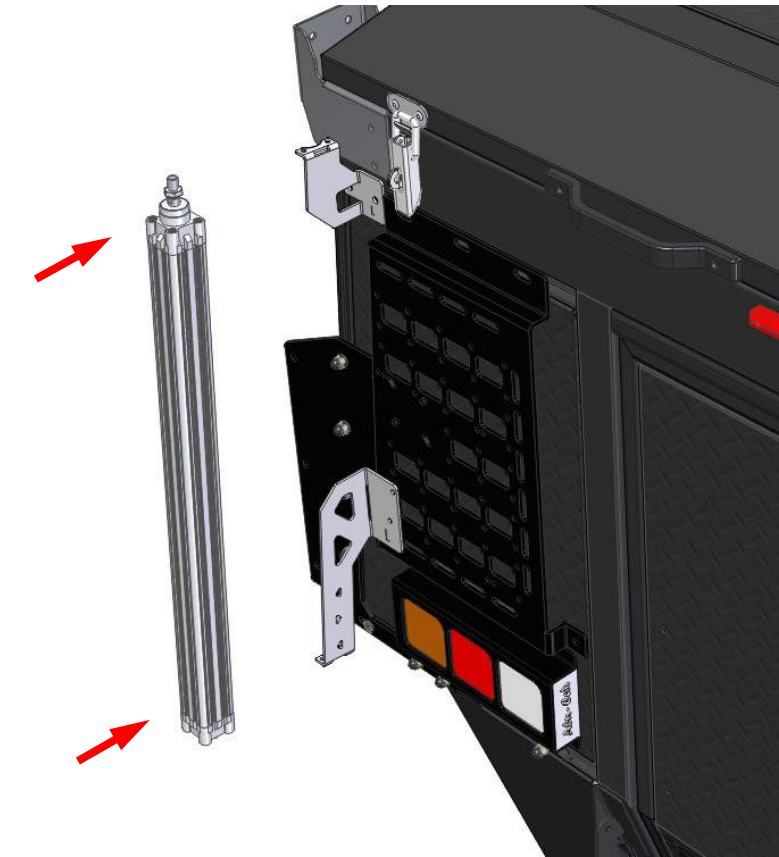

Fasten with M6 bolts supplied on the pneumatic strut

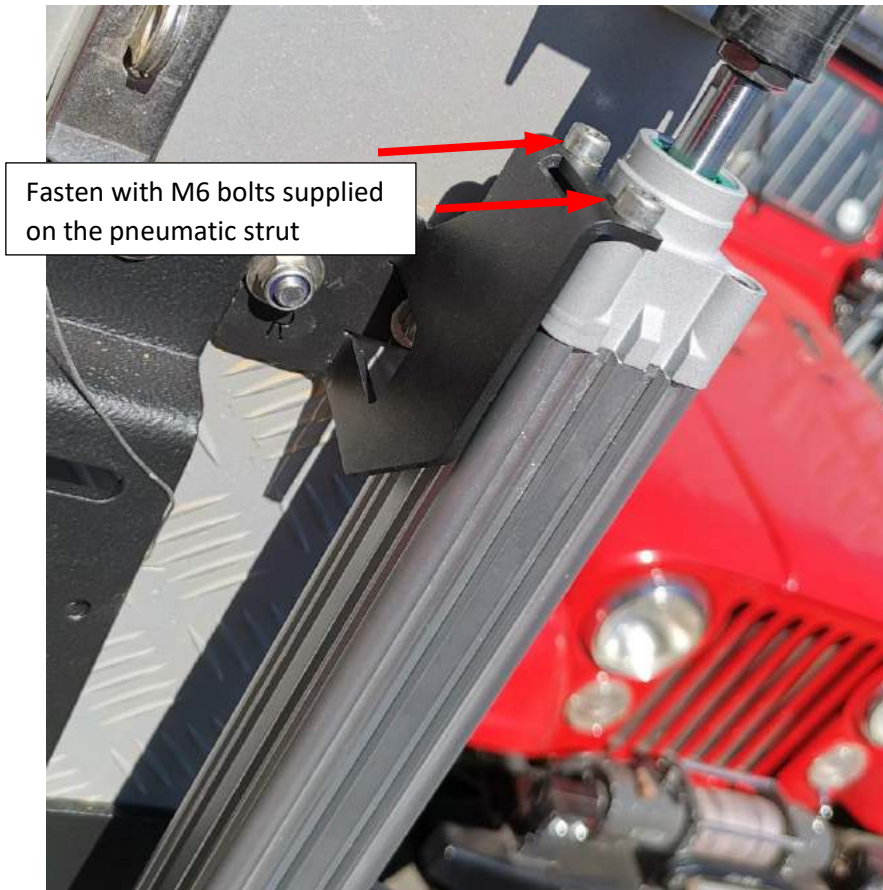

Fasten both left and right pneumatic struts onto the Khaya.

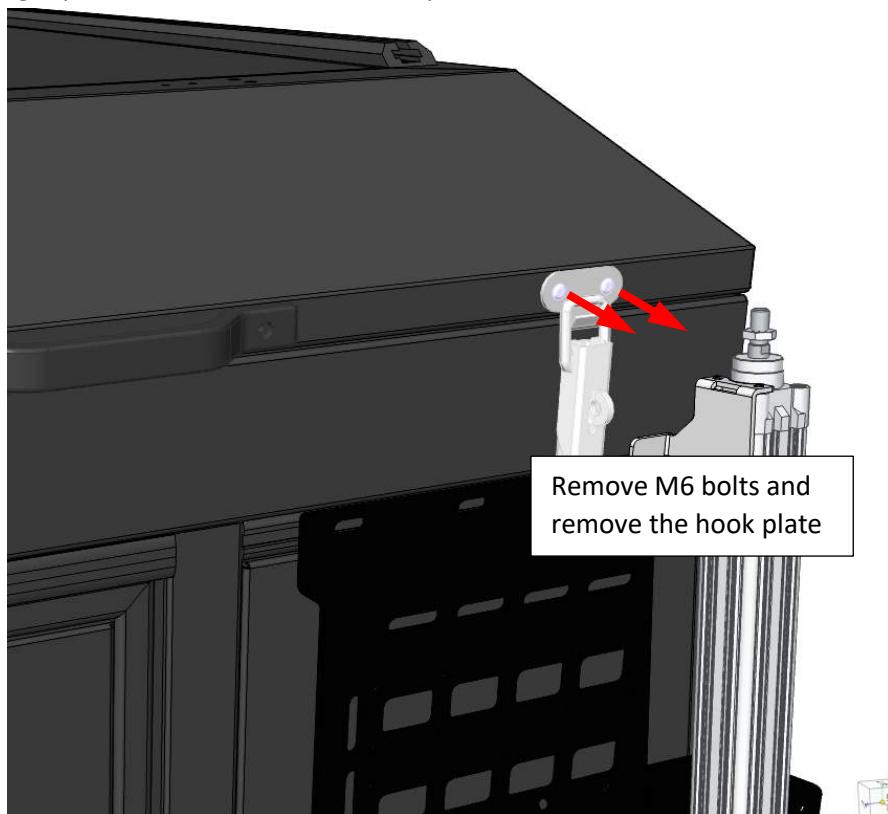

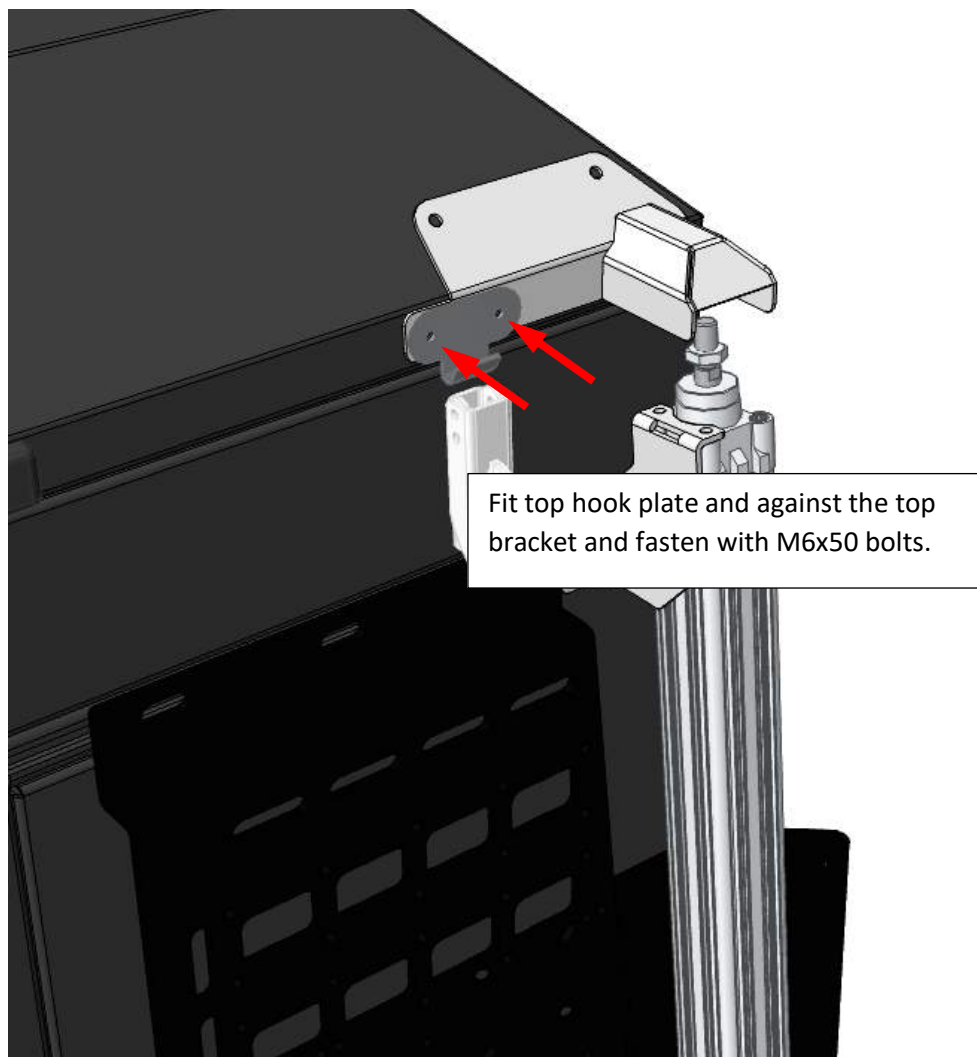
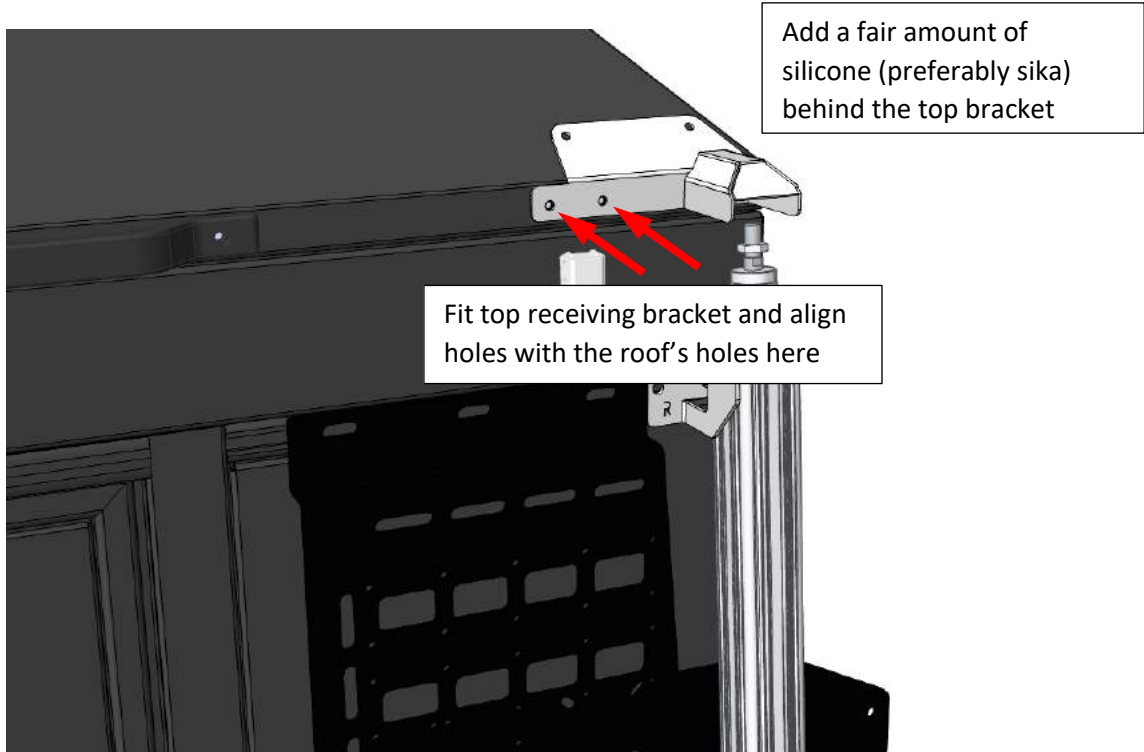



#### 4. Fitting the Air Assist Box



Air box placed inside the RHS cupboard shown in the image above.

Do not push the air box all the way to the rear of the cupboard, at least 10mm is needed to remove the lid, then you will see mounting holes as seen below:

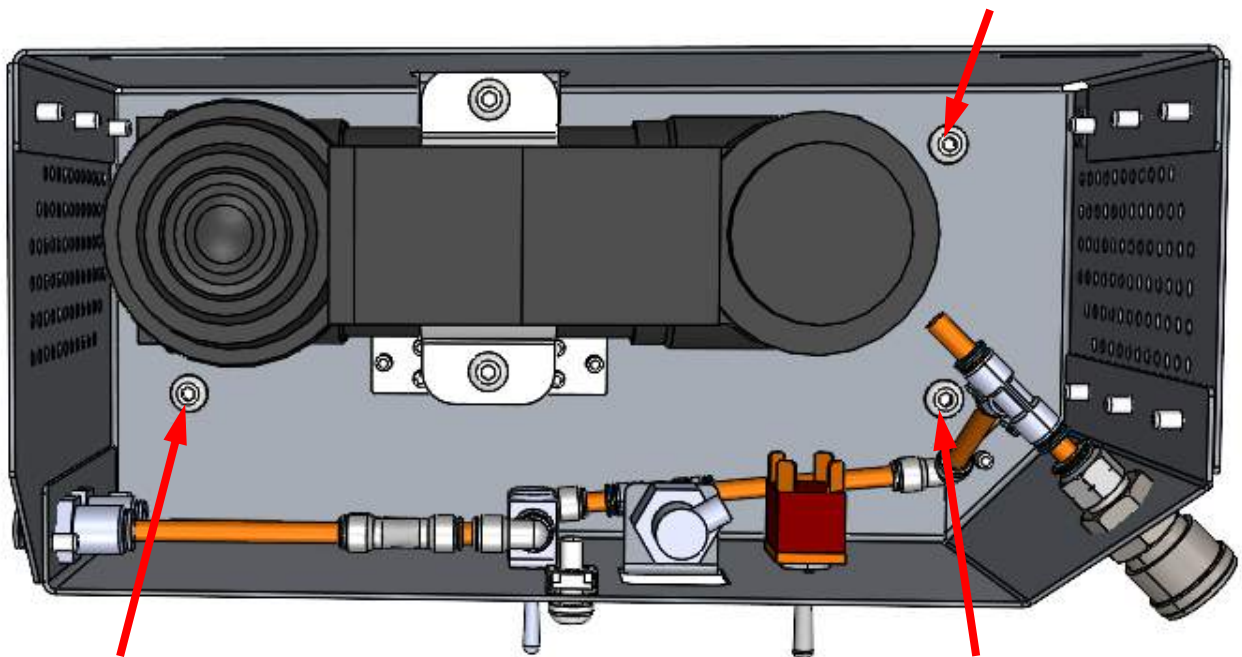

Using these holes as a guide, mark out points to be drilled. At least 2 of the 3 holes can be used. Use one of the cable cradles supplied to guide the cable to the fuse box. Leave the top lid off until the complete system is installed.

## 5. Connecting the power

The power cable can be connected to any available fused power supply

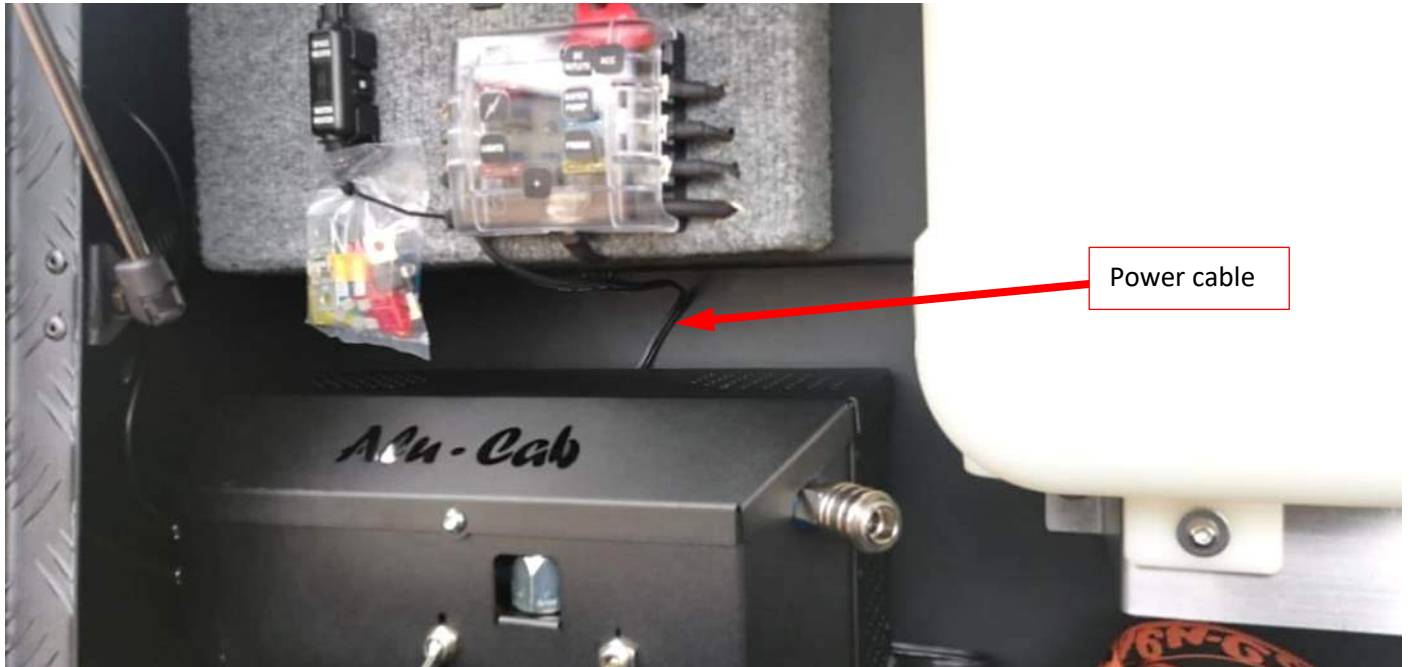

## 6. Adjusting the pressure switch



To adjust the pressure switch, start by turning the internal screw in completely then unscrew with quarter turns until you reach the desired lift. If cargo is loaded on the roof then this will need to be adjusted again.